

REVISIONS				
SYM	DATE	EO NO.	BY	APPR
A	11/30/17	44820	DMR	TH
B	5/21/18	45015	DMR	TH
C	9/17/18	45169	DMR	TH
D	12/19/19	45711	DMR	TH
E	4/28/20	45833	DMR	TH

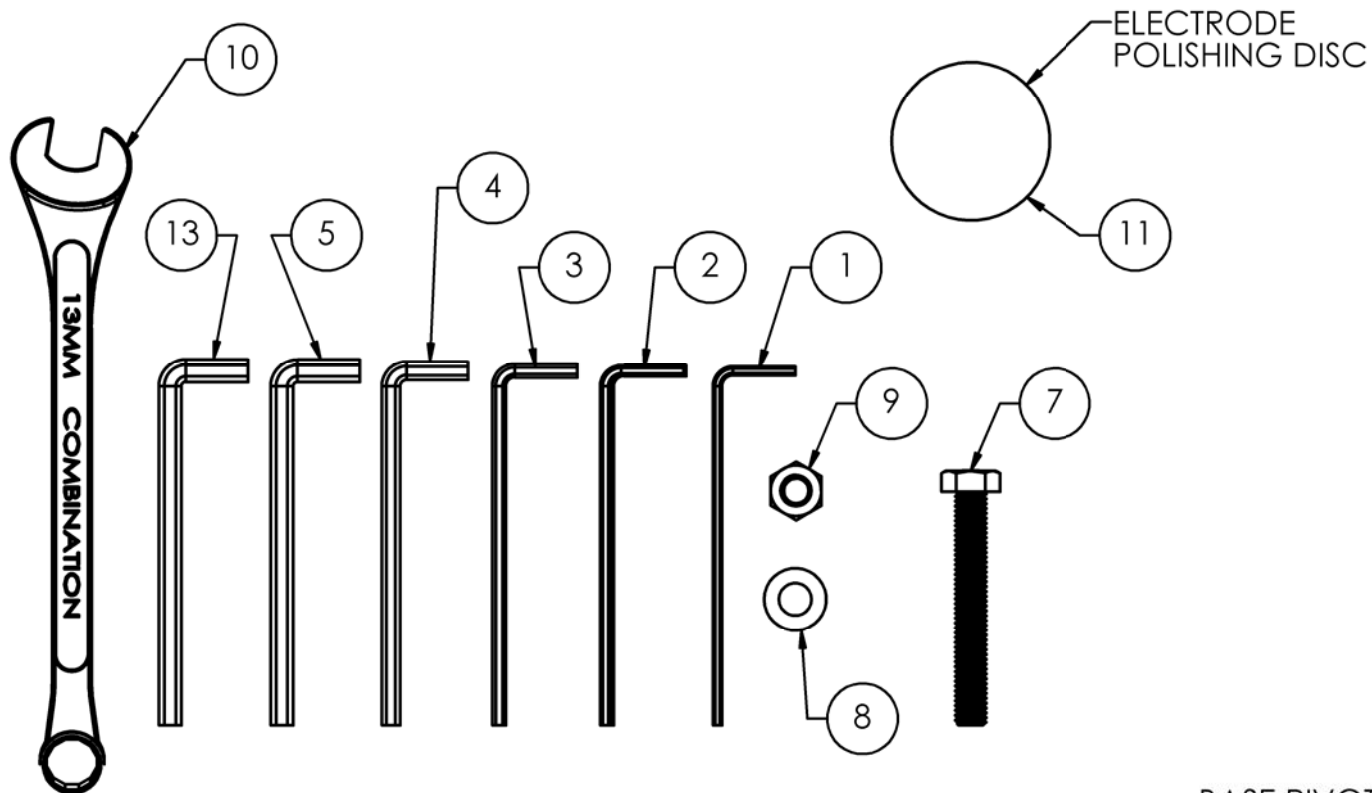

TOOL USAGE CHART		
ITEM #	DESCRIPTION	USE FOR
10	13mm COMBINATION WRENCH	ALL 8mm HEX BOLTS
3	3.0 mm ALLEN KEY	ELECTRODE HOLDER
4	4mm ALLEN KEY	WELD CABLE END CONNECTIONS
5	5mm ALLEN KEY	CP CABLE ACTUATOR BLOCK
2	2.5mm ALLEN KEY	ELECTRODE LOWER PIVOT MOUNT
1	2.0 mm ALLEN KEY	CP ACTUATOR, BARREL RETENTION
13	6.0mm ALLEN KEY	POWER SUPPLY WELD CABLE CONNECTIONS

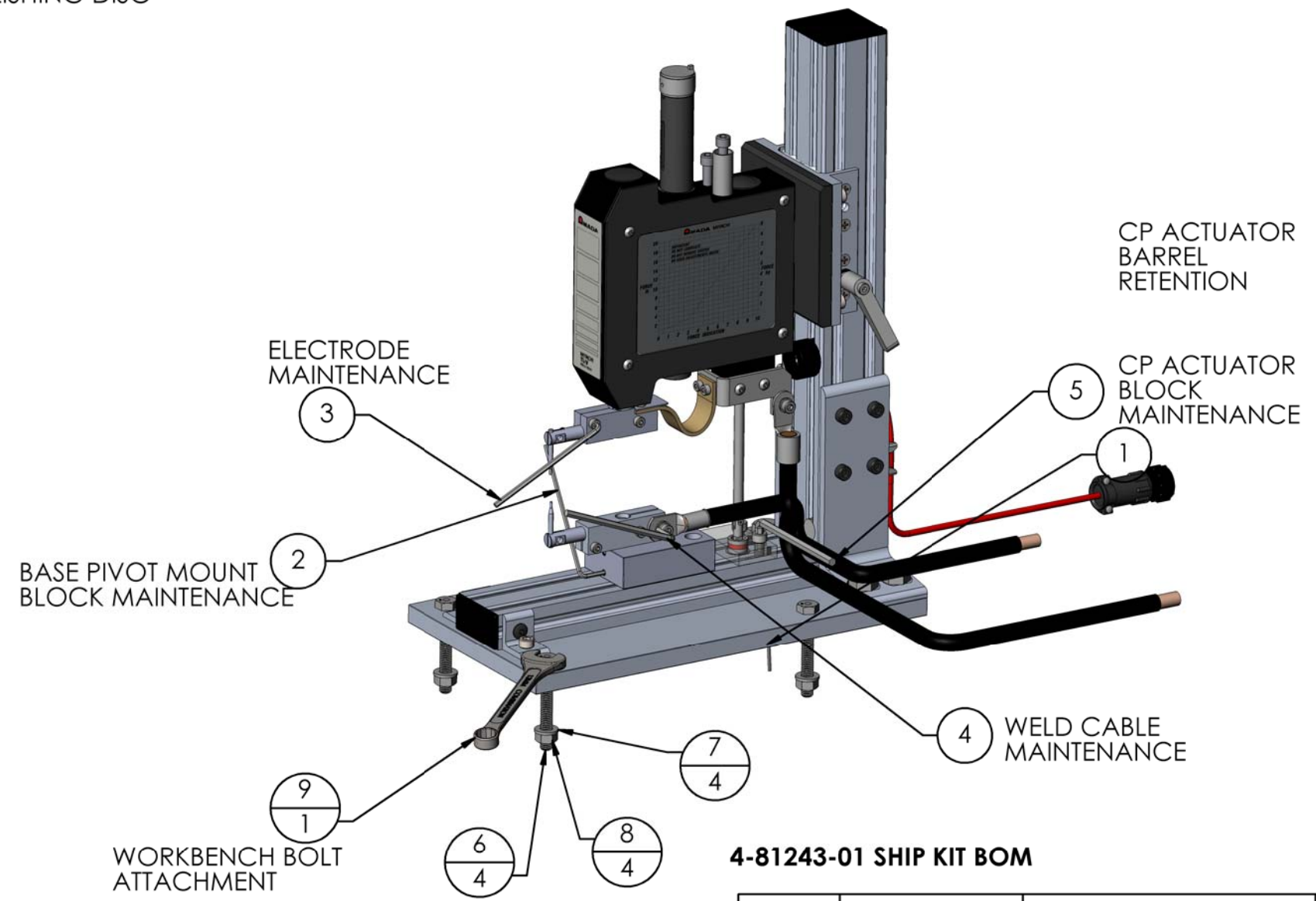

4-81243-01 SHIP KIT BOM

ITEM NO.	PART NUMBER	DESCRIPTION	Default/ QTY.
1	770-047	2mm HEX ALLEN WRENCH	1
2	770-045	2.5mm HEX ALLEN KEY	1
3	770-032	3mm HEX ALLEN WRENCH	1
4	770-043	4mm HEX ALLEN WRENCH	1
5	770-027	5mm HEX ALLEN WRENCH	1
6	160-006	BOLT, HEX HEAD, M8, 60mm LG	4
7	755-420	WASHER FLAT, M8	4
8	465-289	HEX NUT, M8, 18-8 SS	4
9	770-033	WRENCH, 13mm, OPEN END	1
10	4-04688-01	POLISHING DISC (600 GRIT)	1
11	4-40802-01	TEMPLATE MTG, 80F CD	1
12	4-40854-01	INSTALLATION DWG	1
13	770-031	WRENCH HEX KEY, 6mm	1

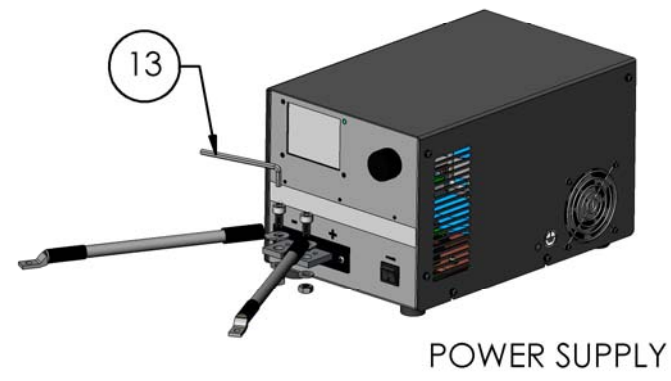

POWER SUPPLY

PN 4-40806-01

UNLESS OTHERWISE SPECIFIED DIMENSIONS ARE IN INCHES/		MATERIAL: STK NO.		DRAWN: DAVE R DATE: 10/20/17	
DIMENSIONAL TOLERANCES		FINISH:		ENGR: DATE:	
INCHES .XX ± .01 .XXX ± .005 FRACT ± 1/64		AMADA		CHKD: DATE:	
MM .X ± .3 .XX ± .13		AMADA WELD TECH INC. CALIFORNIA		APPR: MATT G DATE: 10/20/17	
ANGLES ± 1/4°		TITLE		APP: DATE:	
SURFACE ROUGHNESS 125 MAX BREAK ALL SHARP EDGES TO RADIUS (OR EQUIV)		SHIP KIT DRAWING, TL-V080B-F SINGLE HEAD		RELEASE EO: SCALE: NONE	
ALL INTERNAL RADIUS PART TO BE FREE OF BURRS CONCENTRICITY REMOVE MILL SCALE		SIZE DWG NO. D 4-40806		REV E	
2-360-01	4-81243	1		SHEET 1 OF 1	
MODEL	DEFINING BOM ASSY	REQD PER UNIT			

NOTES: UNLESS OTHERWISE SPECIFIED